



## Ground Floor Treatments

AMS offers a non-thermally broken Ground Floor Treatments System comprising of a wide range of framing solutions for all types of commercial entrances and screens. Flush glaze screen profiles are designed for use in Ground Floor applications such as retail units in moderately exposed locations.

### Introduction

The system can accommodate both single and double glazed applications of 6-12 mm and 20-24 mm thickness respectively. Framing sections are all 45mm wide and 100mm deep in box sections. The system consists of both flush glaze, box and bead.

### Thermal Performance

The system is a non-thermally broken commercial screen solution.

### Scope

This specification defines materials, fabrication, paint finishes, and size limitations for Ground Floor Treatments.

### Materials

Aluminium profiles are extruded from aluminium alloy 6063 T5 and T6 complying with BS1474 – BS EN 12020-2:2001 / BS EN 755-9:2001.

### Paint Finishes

#### Polyester Powder Coatings

Aluminium profiles are single colour polyester powder coated to BS6496.

AMS offers in house painting with the following paint suppliers :

- Azko Nobel Interpon D
- Du Pont Alestia
- Beckers Powder

#### Decoral

Aluminium profiles can be polyester powder coated with a woodgrain effect paint finish to BS6496.

#### Anodised

Aluminium profiles can be anodised to BS1615 or BS3987.



# BOX & BEAD SYSTEM

Profile Listing - box section  
Scale 1:2

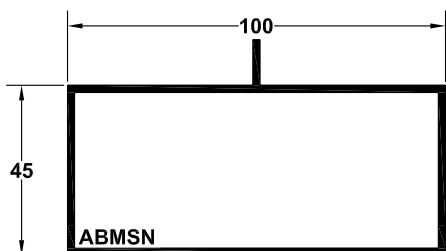

100 X 45 SINGLE NIB

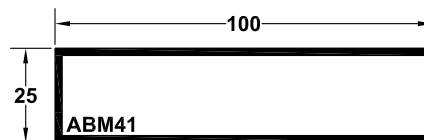

100 X 25 PLAIN BOX

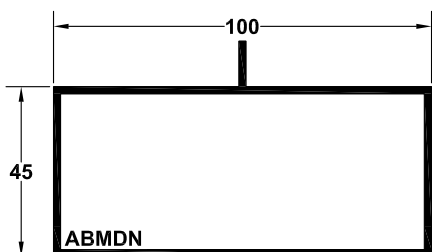

100 X 45 DOUBLE NIB

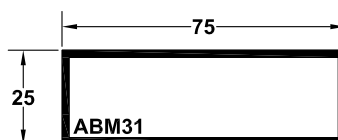

75 X 25 PLAIN BOX

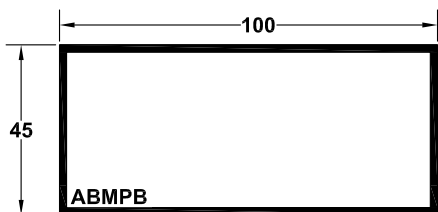

100 X 45 PLAIN BOX

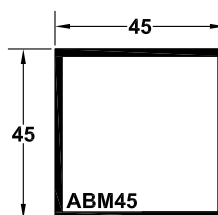

45 SQUARE BOX

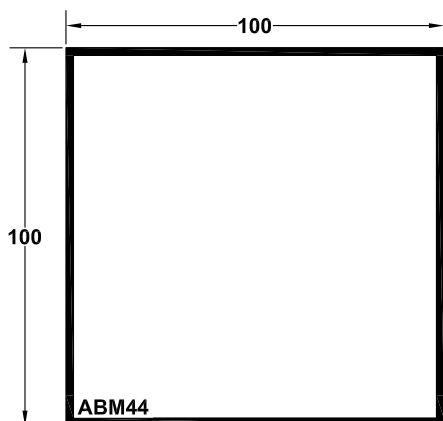

100 X 100 PLAIN BOX

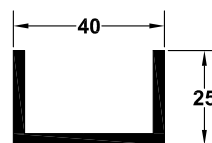

BOX CLEAT  
ABC



1/2" BOX BEAD  
ABMB



1/2" ANGLE  
SA12



Bead Studs  
ABB



DST  
Double sided  
tape

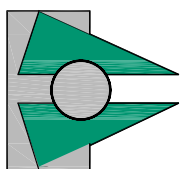

# BOX & BEAD SYSTEM

Details - Double Glazing

Scale 1:2

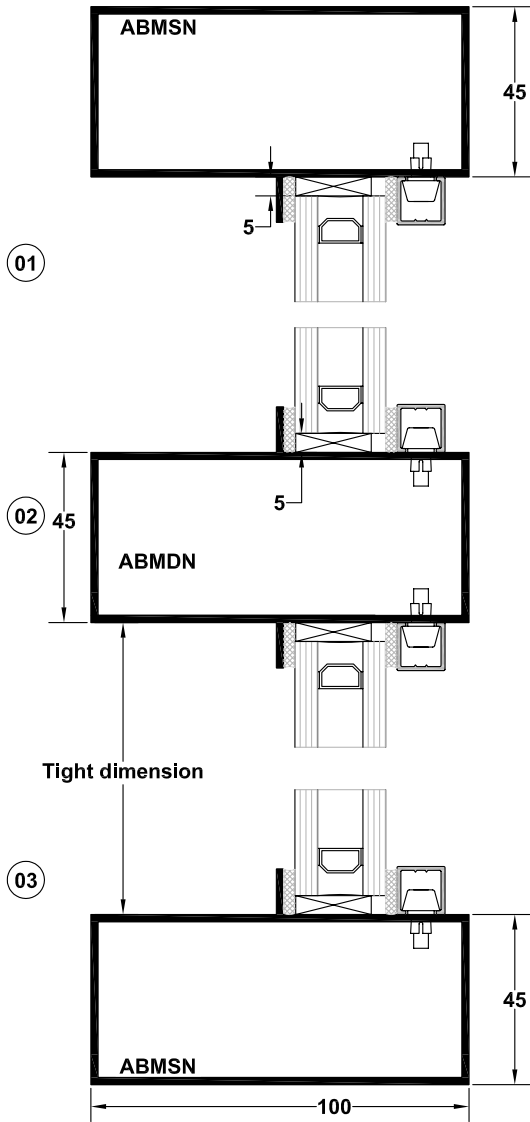

Tight dimension

Note:  
Glass Dimension = Tight size - 10mm

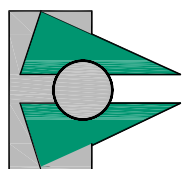
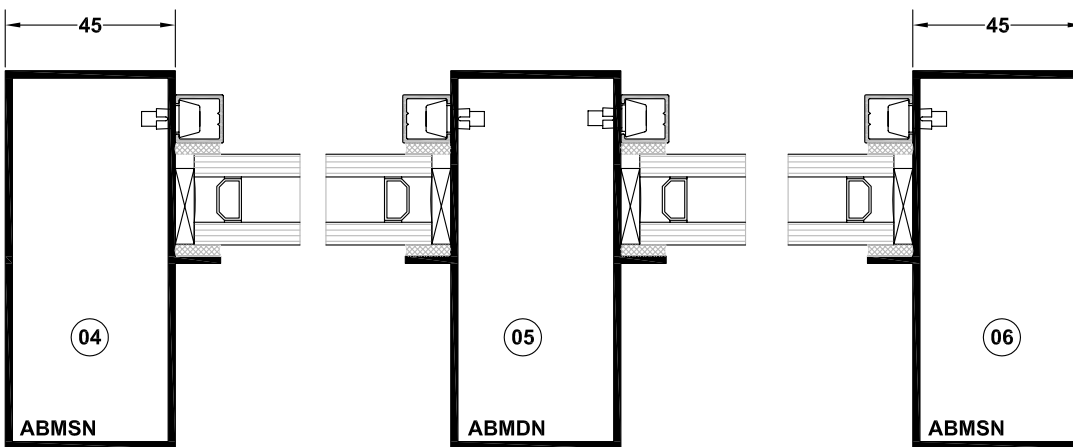
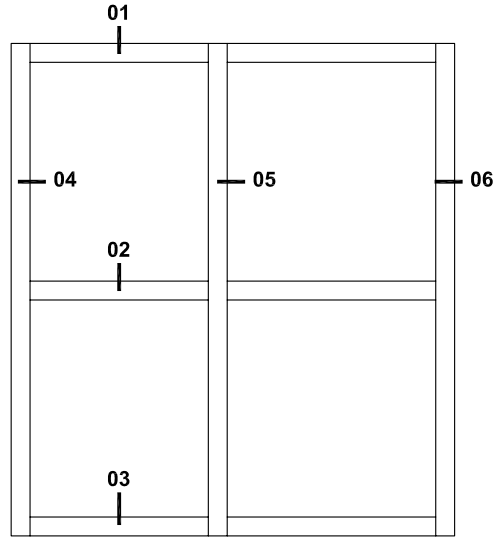

# BOX & BEAD SYSTEM

Details - Single Glazing

Scale 1:2

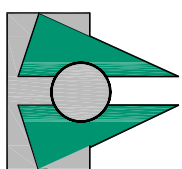
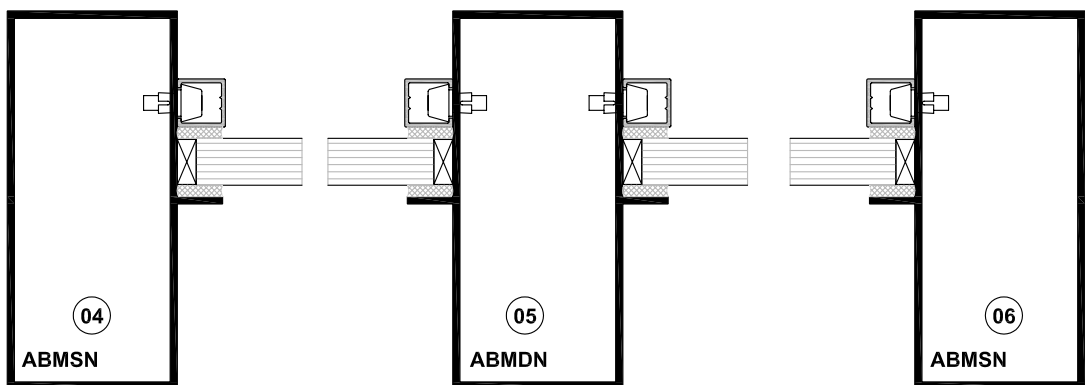
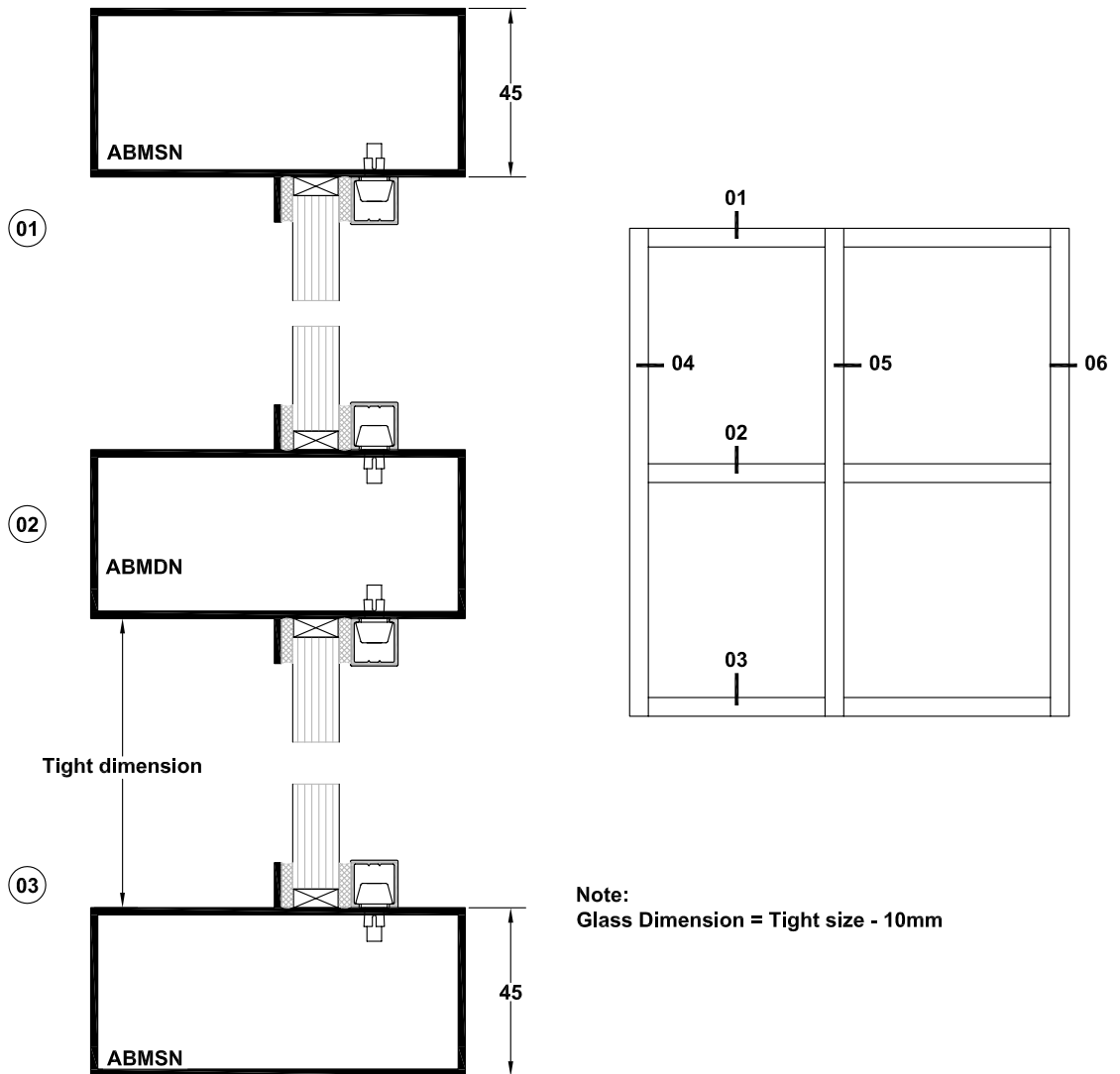

# BOX & BEAD SYSTEM

Corner details

Scale 1:2

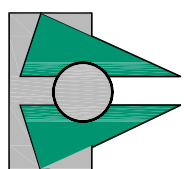
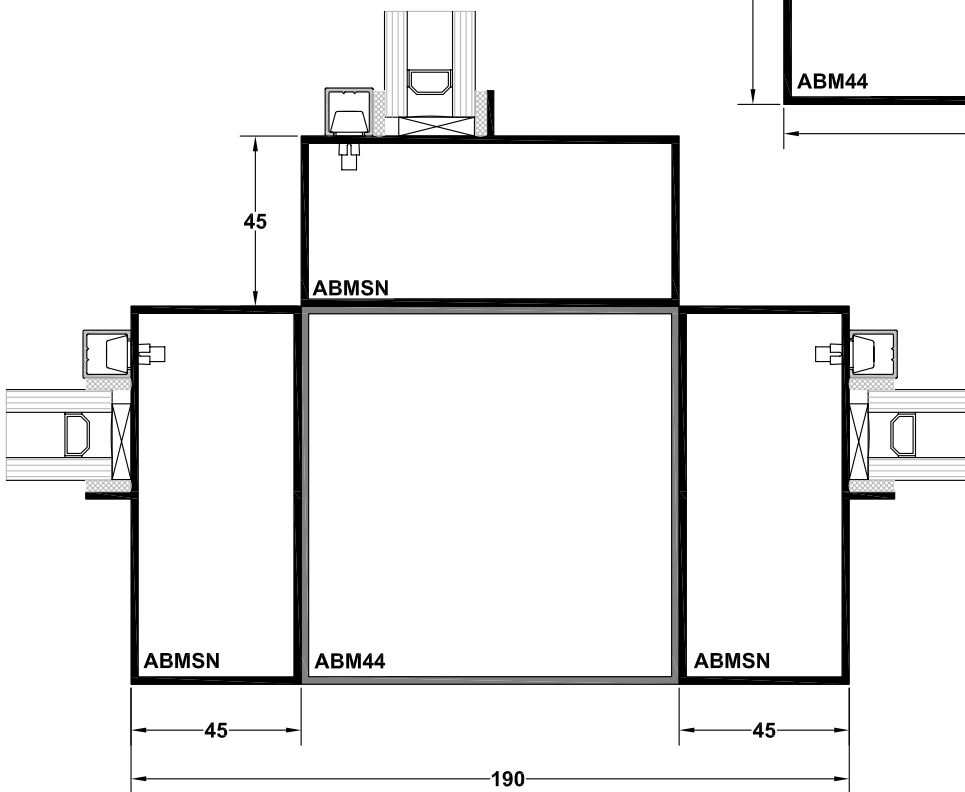
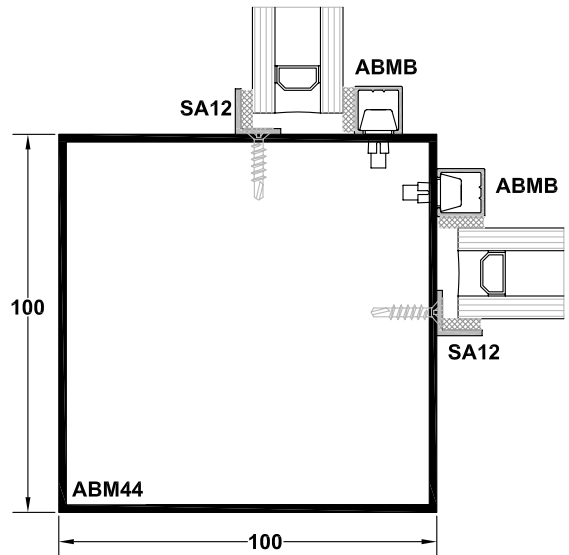
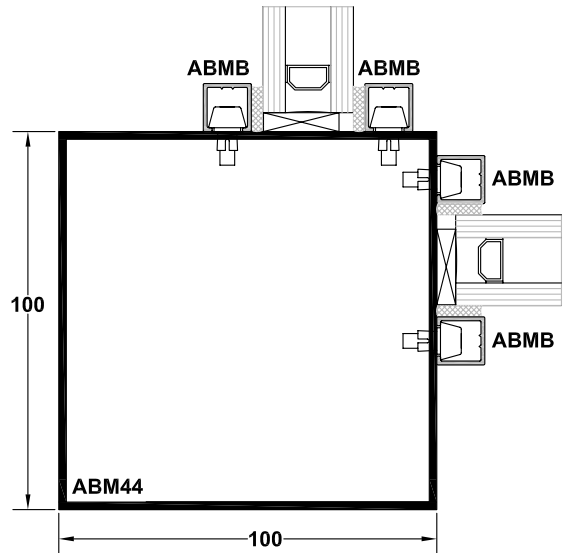
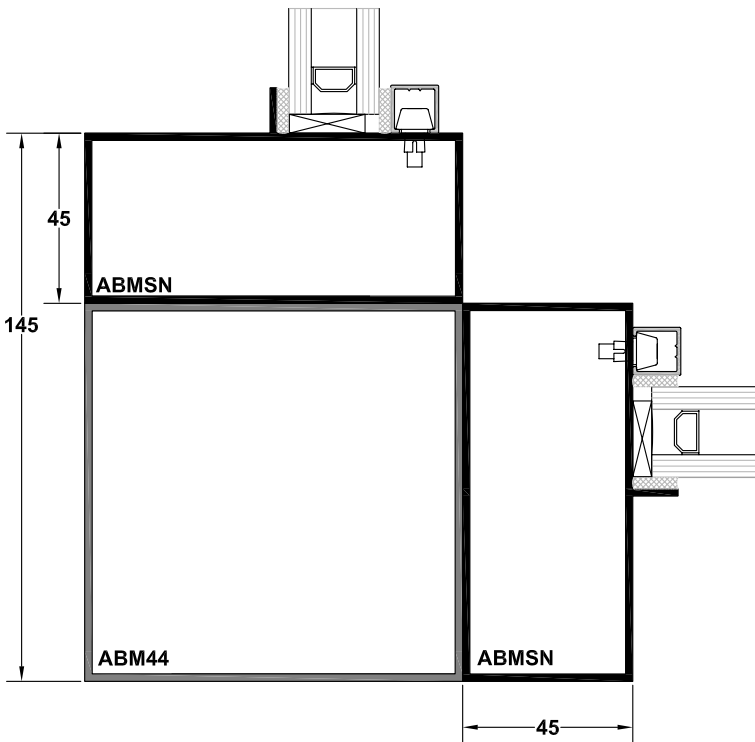

# BOX & BEAD SYSTEM

Door interface details

Scale 1:2

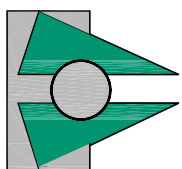
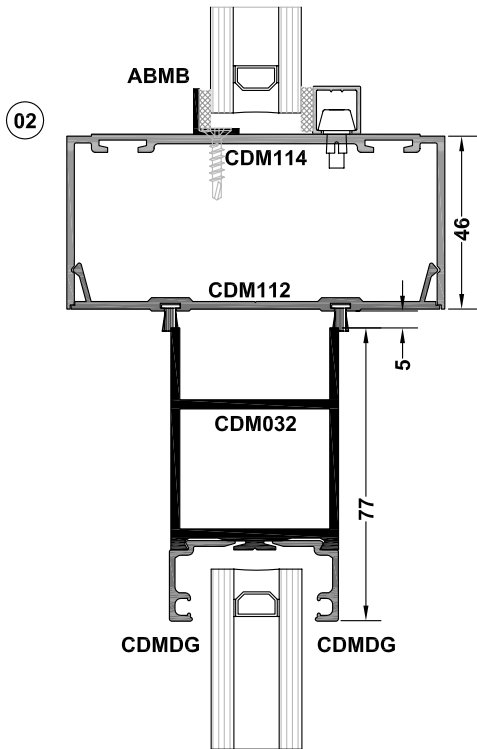
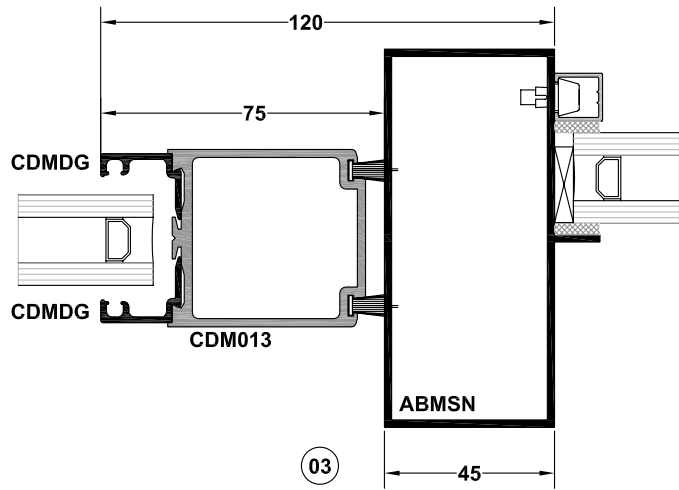
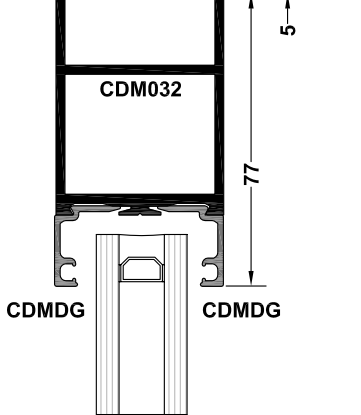
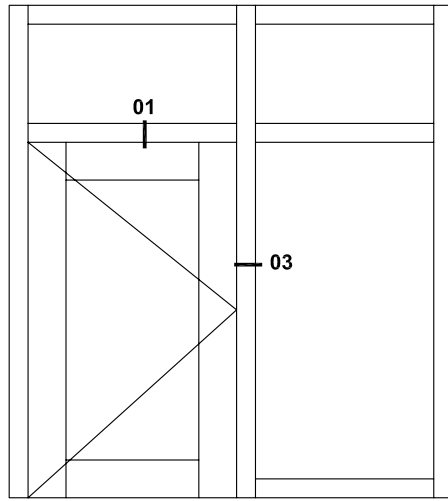
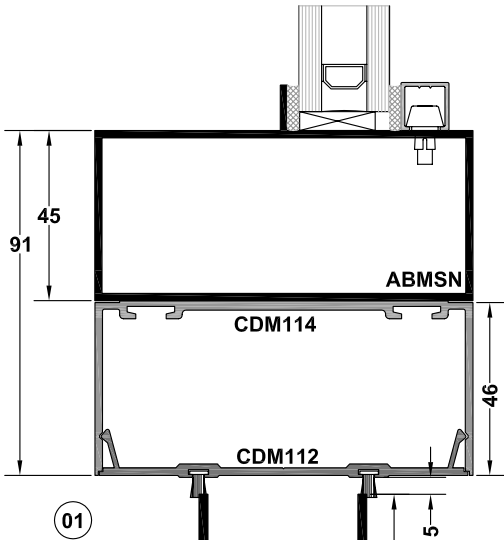

# BOX & BEAD SYSTEM

Automatic door details

Scale NTS

